

Fire Safety in Private Healthcare Facilities



Important Notice

- ▶ All rights, including copyright, in this PowerPoint file are owned and reserved by the Hong Kong Fire Services Department. Unless prior permission in writing is given by the Director of Fire Services, you may not use the materials other than for your personal learning and in the course of your official duty.

重要告示

- ▶ 香港消防處持有並保留本簡報檔案包括版權在內的所有權益。除預先獲得消防處處長書面許可外，本簡報檔案只可用作個人學習及處理公務上用途。

Overview

- ▶ Risk Assessment
- ▶ Firefighters' Challenges
- ▶ Mitigation Measures
- ▶ Statutory Requirements

Risk Assessment - Fire

Risk - the likelihood that a person may be harmed or suffer adverse effects if exposed to a hazard

Anticipated risk	Risk nature
Fire risk	<ul style="list-style-type: none"><li data-bbox="494 701 1742 911">• Ignition sources: naked flames, faulty or misused electrical equipment, cooking equipment, hot surfaces, human factors<li data-bbox="494 958 1837 1096">• Fire load: flammable liquids, medical gases, fuel, furniture, mattress, personal effects,<li data-bbox="494 1143 1768 1210">• Oxygen: oxidizing agents, medical oxygen<li data-bbox="494 1253 1039 1310">• Nearby buildings

Risk Assessment - Life

Anticipated risk	Risk nature
Life risk	<ul style="list-style-type: none"><li data-bbox="728 454 1416 515">• Clientele dependency<li data-bbox="728 562 1009 624">• Density<li data-bbox="728 671 1607 801">• Activities: sleeping, medical treatment<li data-bbox="728 848 1294 909">• Human Behaviour<li data-bbox="728 956 1340 1018">• Risk to Firefighters

Siting Concerns

Factor	Nature
Siting	<ul style="list-style-type: none"><li data-bbox="677 411 1454 468">• On / Off-site Assessment<li data-bbox="677 515 1582 572">• Accessibility of FS appliances<li data-bbox="677 619 1166 676">• Water supplies<li data-bbox="677 723 1116 781">• Co-existence

Firefighters' Challenges

Rapid fire growth



Firefighters' Challenges

Affected by neighboring buildings

Firefighters' Challenges

Vulnerable group of people

- ▶ Restricted mobility
- ▶ Under medication
- ▶ Dependent on electrical/mechanical equipment

Firefighters' Challenges

Emergency Evacuation

Firefighters' Challenges

**Massive engagements of logistic support
and manpower**

Firefighters' Challenges

Evacuation constraints - Tenability limit

Smoke layer height: 2-2.5m

Ambient temperature $>60\text{ }^{\circ}\text{C}$

Radiated heat: $2.5\text{kW}/\text{m}^2$

Toxicity:
CO 6,000ppm
HCL 500ppm
HCN 150ppm

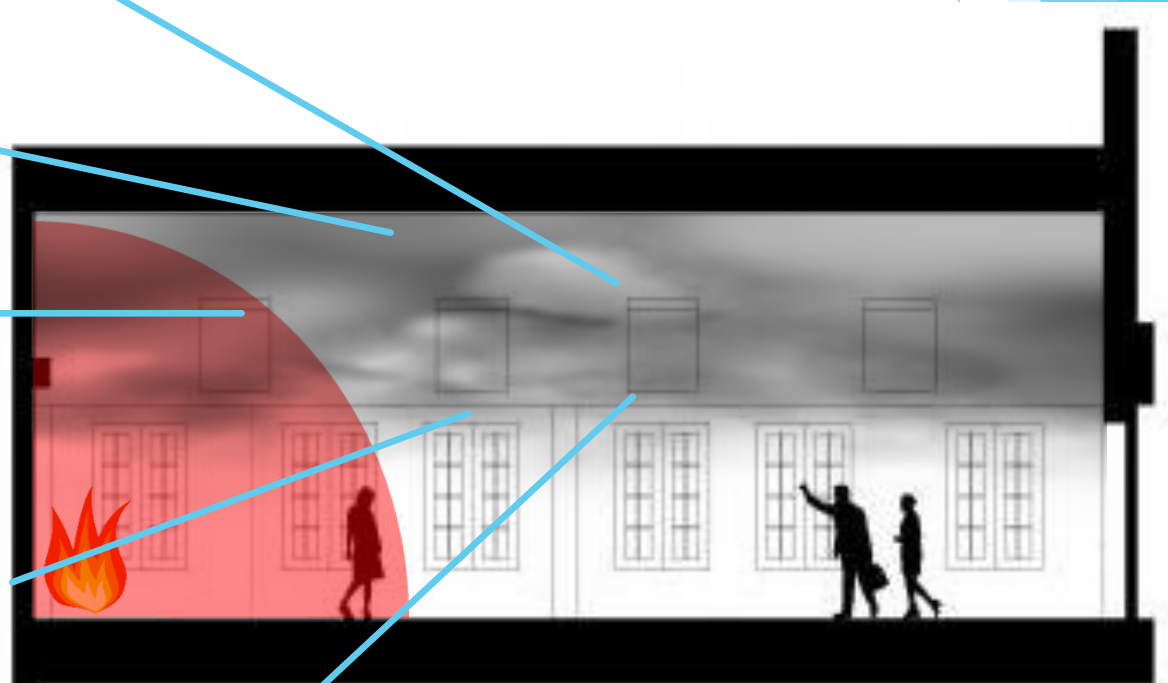

Visibility: 10m

Firefighters' Challenges

Evacuation constraints - Human factors

Normal Person
 $ASET > RSET$

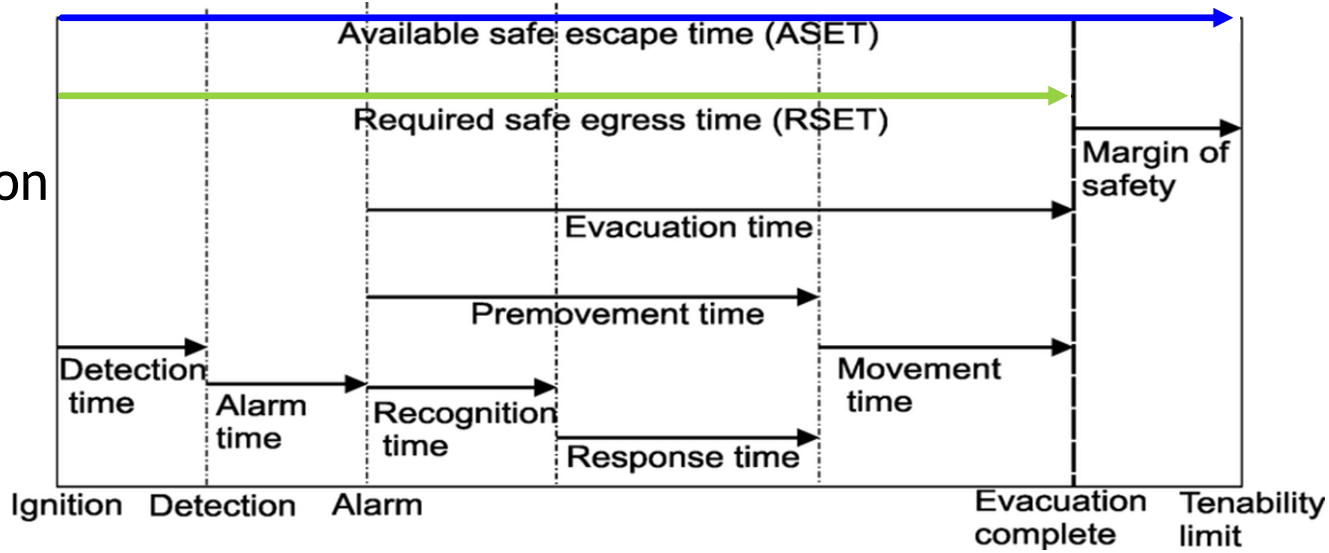

Vulnerable group of people
 $RSET > ASET$

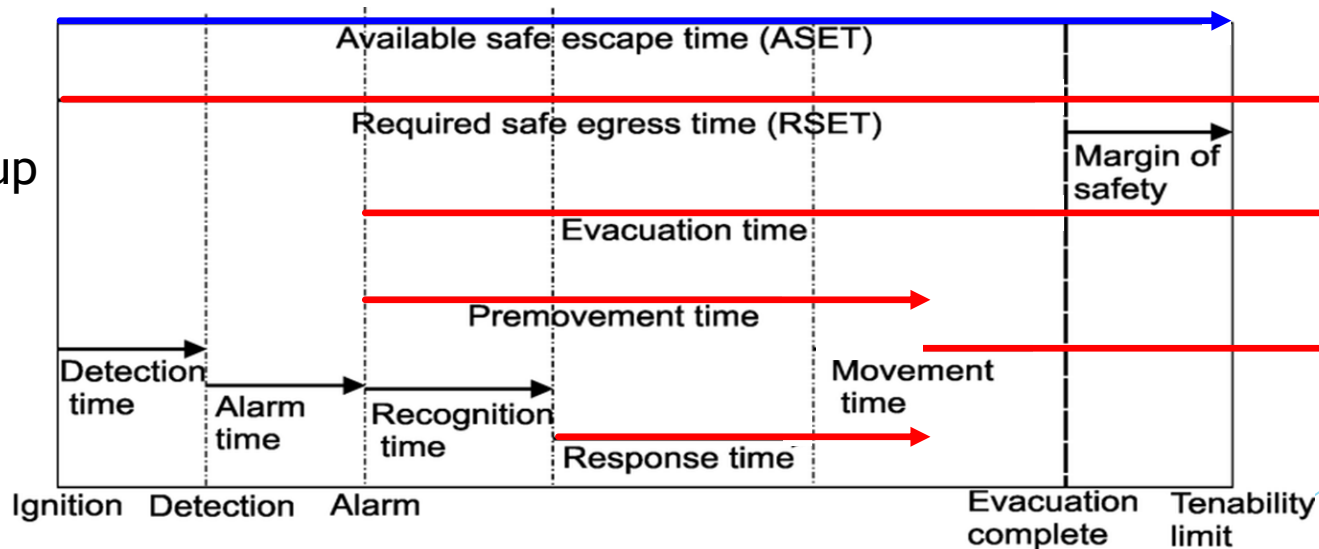

Mitigation Measures - Fire Risk

Preventing, attacking & limiting the fire

Anticipated risk	Mitigation Measures
Fire risk	<ul style="list-style-type: none">• Automatic fire detection system• Sprinkler system• PU foam (Fire retardant)• Dangerous Goods control• Fire resistance rating• Fire safety management plan• Housekeeping

Mitigation Measures - Life Risk

Facilitate evacuation

Anticipated risk	Mitigation Measures
Life risk	<ul style="list-style-type: none"><li data-bbox="682 554 1302 615">• Emergency lighting<li data-bbox="682 662 996 723">• Exit sign<li data-bbox="682 771 1467 832">• Reduce clientele number<li data-bbox="682 879 1291 941">• Compartmentation<li data-bbox="682 988 1747 1049">• Number of escape routes and exits<li data-bbox="682 1096 1319 1158">• Evacuation strategy<li data-bbox="682 1205 1607 1266">• Management of escape routes

Mitigation Measures - Siting

Factors to be considered

	Control Measures
Siting	<ul style="list-style-type: none">• Building design• Emergency vehicular access (EVA)• Fire fighting water supplies• Co-existence with other business• Fire Safety Management

Crucial Risk Mitigation Measures

Fire Evacuation Strategy - Vulnerable group of people

Horizontal evacuation

To an adjoining fire compartment

Vertical evacuation

Additional risks are present to clientele during vertical escape phase

Statutory Requirements

- Fire Services Ordinance, Cap. 95, Laws of HK
- Dangerous Goods Ordinance, Cap. 295, Laws of HK
- Fire Safety (Commercial Premises) Ordinance, Cap 502, Laws of HK
- Fire Safety (Buildings) Ordinance, Cap 572, Laws of HK

Fire Services Ordinance, Cap.95

- Passageways, corridors, staircases, staircase landings and smoke lobbies clear from obstruction
- Smoke stop doors closed and unlocked
- Fire Service Installations or equipment in efficient working order
- No obstruction to any Fire Service Installations and equipment
- Annual inspection of FSI by Registered Fire Service Installations Contractor

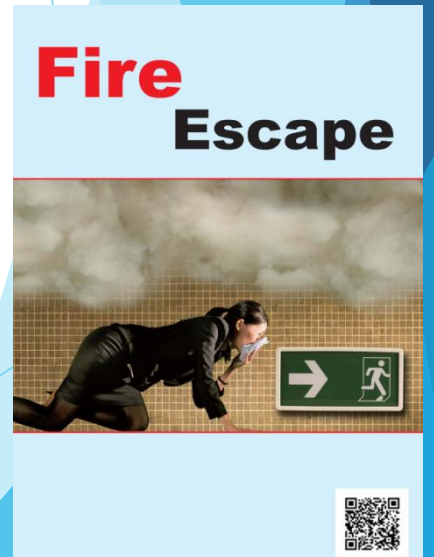
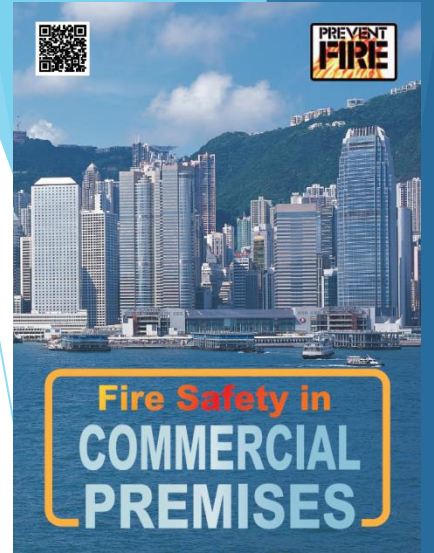

Dangerous Goods Ordinance, Cap.295

- Manufacture
- Store
- Convey
- use



防火通告第四號
FIRE PROTECTION NOTICE NO.4

危險品
DANGEROUS GOODS

危險品條例(第295章)
Dangerous Goods Ordinance (Chapter 295)

2016年4月
April 2016

Fire Safety (Commercial Premises) Ordinance, Cap. 502

Specified Commercial Buildings - Pre 1987

Specified Commercial Premises -

- Banking
- Off-course betting centre
- Jewelry & goldsmith with security area
- Supermarket
- Shopping arcade

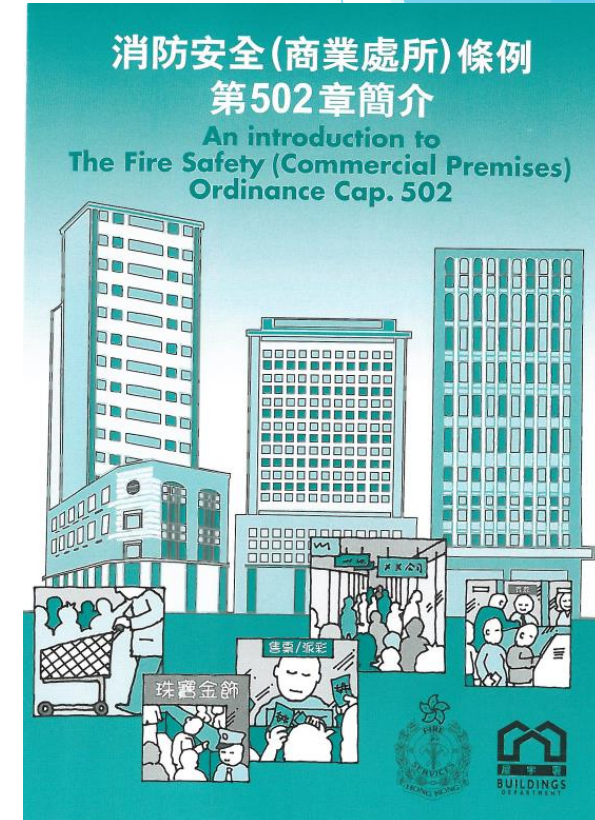

Fire Safety (Buildings) Ordinance, Cap. 572

- Partly for domestic purposes and partly for non-domestic purposes; or
- For domestic purposes with more than 3 storeys; and
- Pre-1987

**An Introduction to
the Fire Safety (Buildings)
Ordinance Cap.572**

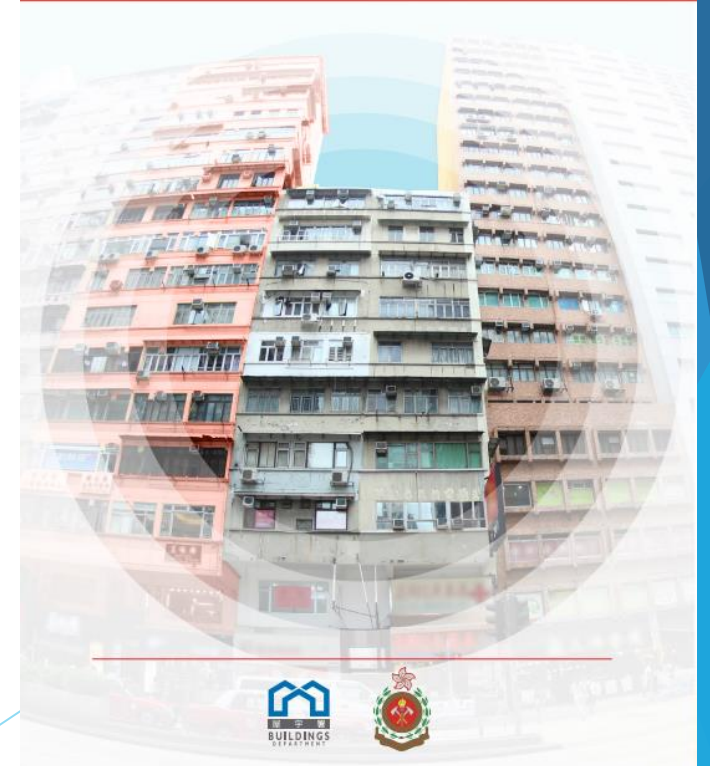

Fire Safety (Commercial Premises) Ordinance, Cap. 502

Fire Safety (Buildings) Ordinance, Cap. 572



Premises/Building		Composite Building / Commercial Building		
		Commercial/Non-domestic Portion (Cap. 502 & Cap.572)		Domestic Portion (Cap. 572 only)
		Owner	Occupier	Owner
Fire Service Installations and Equipment				
Automatic Sprinkler System		✓		
Fire Hydrant and Hose Reel System		✓		✓
Manual Fire Alarm System		✓		✓
Emergency Lighting	Common areas	✓		✓
	Non-common areas		✓	
Automatic cut-off device for the mechanical ventilating system	Common areas	✓		
	Non-common areas		✓	
Fire Extinguisher	Non-common areas		✓ (Cap.502)	



Thank you